

NT70H

MOBILE LOBE MOTORPUMP



Nettuno NT70H

Mobile motor pump unit with proven technology of a rotary lobe pump.

Applications:

Waste water plants, agriculture, mining and construction, flooding, chemie and food application.

Function

The Rotary Lobe Pump is a positive displacement pump.

The main components which determine the pumping principle are two lobe rotors rotating in opposite directions within a housing.

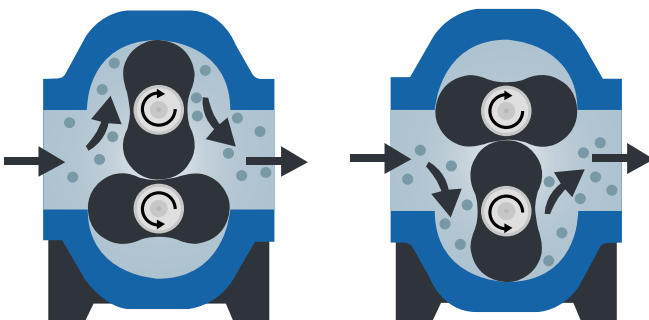

Combining the wear resistance and simple metal-rotor /rubber-stator construction of a progressing cavity pump with traditional rotary lobe pump technology is a design breakthrough that creates the advantage of durability along with simplicity and ease of maintenance.

PUMP

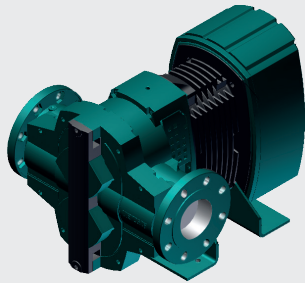

Rotary lobe pump.



Brand	Netzsch
Series	T2
Model	06/70
Flowrate at nominal speed range	12 to 58 appr. m ³ /h
Speed (nominal) recommended range	100 to 500 rpm
Max diameter of solid parts	40 mm
Flowrate at max. speed	70 m ³ /h
Speed max	600 rpm
Discharge pressure (max.) continuous/intermitted	6/8 bar
Displacement (theoretical)	1,90 l/r
Flange connetions	100 mm

ENGINE

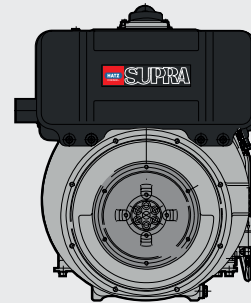
Air cooled single-cylinder
4-stroke diesel engine

Brand	HATZ
Series	D
Model	1090Z
Fuel	Diesel - 10 liter
Displacement	cc 722,
Power	Kw 1042 - HP 13,9
rpm	Giri 3.000/1'

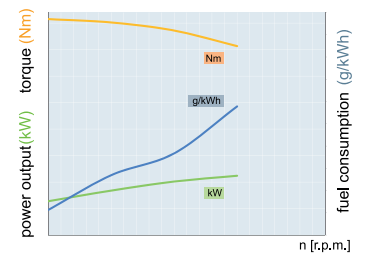
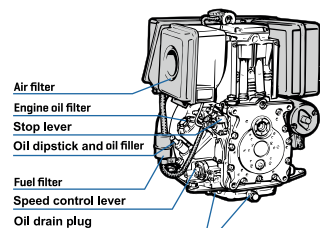

n [r.p.m.]

APPLICATION

Density	0,8 – 1,8 kg/dm ³
Ph Value	2-12
Solid content (w/w)	12% Fibers / 60% Minerals
Dinamic viscosity	max.50.000mpas

The data contained in this document is nominal and refers to the standard equipped model and is not binding. Nettuno reserves the right to revise the information without notice per our policy of continuous product development and improvement. All brands are property of their respective owners.